

N1 ROLL FORMING LINE mod. PRH 24/550 for "Isea" slide

MAIN FEATURES

. Material to be processed	:	Coils
- Type	:	Mild / galvanised steel
- Max weight	Kg :	1 500
- Maximum thickness	mm :	3
- Max. production speed	m/1' :	15
. Electrical supply	V :	400
	Hz :	50
. Motors Brushless AKM74P	Kw :	10,2
Alternating current	HP :	12,5

DESCRIPTION

① MANUAL DECOILER mod. DMR 315

. Capacity	Kg :	1500
. Maximum width	mm :	400
. Centering	mm :	450-650
- Adjustable diskbrake		
- Manual operated centering		



② ROLL FORMING MACHINE mod. PRH 24/550

. Maximum width between stands	mm :	300
. Maximum width over stands	mm :	250
. Diameter of shafts	mm :	70
. Number of forming stations	N :	16 (frame allowed for 24)
. Brushless motor + electronic control	KN/m :	43

- **one piece table**, from planed steel with lining up grooves for the transmission uprights
- N16 stations with special **cast-iron stands**, housing large bearings of the best domestic and foreign brands.
- Steel roller shafts, entirely ground with 10 mm slots.
- **Upper rolls shafts adjustable** according to the thickness to be worked, with graded vernier scale for setting.
- **Adjustable** introducing **guides** to line up the strips on the different sets of rolls
- Group of straighteners lined up on each set of rollers
- Motorization brushless Kolmorgen **direct**
- **One piece** transmission **shaft** Ø mm 40 from the motor **to the different stations** with conical gears
- Start up directly from the main electrical panel, or from a **remote control** box with forward and backward.

③ ELECTRICAL EQUIPMENT AND HANGING UP ADJUSTABLE CONTROL PANEL

- | | |
|---|--|
| <ul style="list-style-type: none"> • P.C. industrial mod. CNC 104 : | <ul style="list-style-type: none"> - video TFT touch screen colors 10" - Windows 8.1 - P .C. office - internet |
| <ul style="list-style-type: none"> • Control by CNC : | <ul style="list-style-type: none"> - punching, - cutting, - synchronization introducing / cutting – punching / forming |



☎ : + 33 (0) 4.93 70.20.19 - 📠 : + 33 (0) 4.93 77.81.84 - 📧 cometal.machines@wanadoo.fr
 Parc Industriel du Carré – 06130 GRASSE - France
www.cometal.imal-industries.fr

④ HYDRAULIC PLANT

- . Tank L : 150
- . Hydraulic unit motor pump HP : 12,5
- . Nb of electrovalves n : 3+1



- Adjustable frame after the rolling machine, for the right positioning and lining up of the different cutting units with the suited sets of rolls.

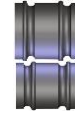

⑤ SETS OF ROLL FORMERS in special tempered and rectified steel as drawings attached

- N1 set of roll formers + straightener for "Isea" slide mm 60 x 50 ép. 1,5 – 1,7

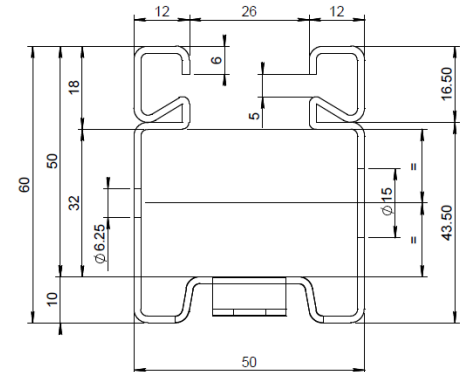

⑥ HYDRAULIC PUNCHING TOOLING

- . Cutting discharge
- . Punches and dies TiAlN coated, fully grinded
- . Stroke electronic control
- . Pneumatic lubrication plant by Venturi system with CNC control

- N1 complete hyd. punching unit for mm 40 x 16

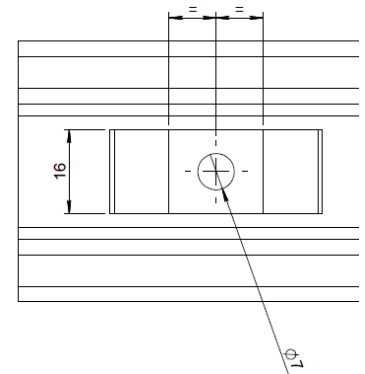

⑦ HYDRAULIC CUTTING TOOLING

- . complete hyd. cutting unit on line
- . blades & matrix of hard and ground steel
- . CNC control
- . hydraulic jack + position electronic sensor

- N1 complete hyd. cutting unit for "Isea" slide

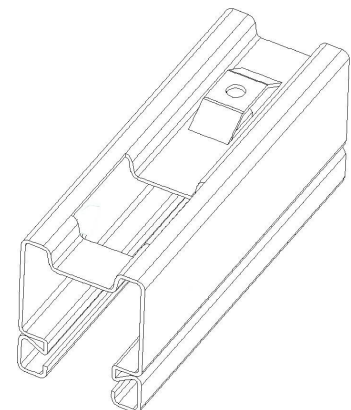

OPTIONAL :

① **Automatic fixing of the joint**

Composition :

- vertical decoiler
- **introducing guides**
- **joint's crimping rolls**

capacity Kg : 300

② **Tooling for bottom slat " mm 118 x 44**

Composition :

- set of roll formers **n16 passages**
- group of straighteners
- complete hyd. **cutting unit**

